

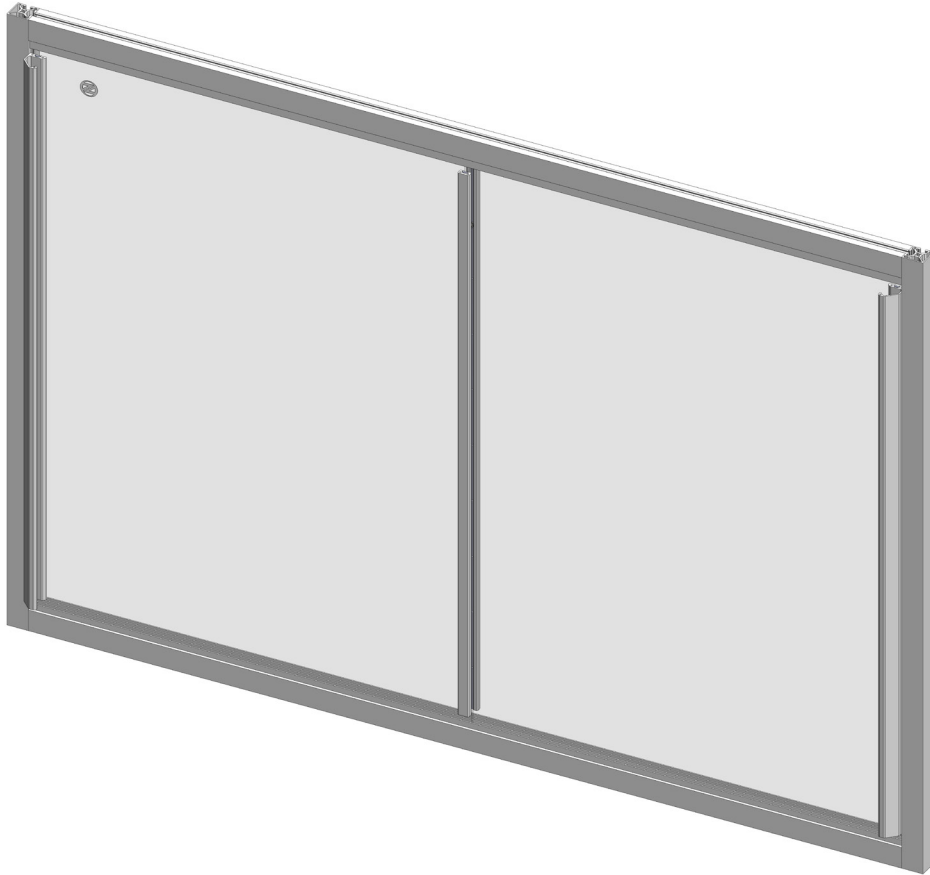

ELITE SERIES

Sliding Access Panel

Install/User Guide



Design and specifications are subject to change without notice.

Proprietary Notice: The information contained in this user guide is the sole property of Subzero Engineering. Any reproduction in part, or as a whole without the written permission of Subzero Engineering is prohibited.

V 1-0_10/01/2022 © 2022 Subzero Engineering. All rights reserved.



World Headquarters

805 South 3600 West
Suite 100
Salt Lake City, UT 84104

p 801.810.3500
f 866.810.3509
e info@subzeroeng.com
w www.subzeroeng.com

Hardware Kit

Safety Information 3

Warranty 3

Hardware Kit 4

Installation 5

Safety Information

- While unpacking use caution with sharp objects such as razors to avoid damaging the product.
- A minimum of two people should be available to install this product.
- While drilling or using power tools safety glasses and gloves should be worn to avoid injury.

1 Year Limited Warranty

Subzero Engineering warrants to the original purchaser that it will, as its sole option, repair or replace this product or any part of this product, if it confirms that the product is defective in materials or workmanship under normal use and maintenance for one year after the purchase date of the product.

This limited 1 (one) year warranty DOES NOT COVER the following:

1. Defects or damage arising from shipping, installation, alterations, accidents, abuse, misuse, lack of proper maintenance and use of other than genuine Subzero replacement parts, in all cases whether caused by a contractor, service company, the owner or any other person.
2. Deterioration through normal wear and tear.
3. Damages resulting from abuse or misuse from failure to install or maintain this product in accordance with the written instructions furnished by Subzero Engineering.
4. Use of Cleaning Products Containing Calcium Hypo Chlorite (Chlorine), Scouring Powders or pads shall not be covered.
5. Expense of normal maintenance.
6. All costs of removal, transportation, labor, reinstallation or other costs including postage and/or shipping costs to obtain warranty service shall be paid by the customer.
7. Any liability for consequential or incidental damages, all of which are hereby expressly disclaimed, and implied warranties, including those of merchantability or fitness for purpose intended are specifically excluded. (Some jurisdictions do not allow limitations on how long an implied warranty lasts, or the exclusion or limitation of incidental or consequential damages, so these limitations and exclusions may not apply to you.)
8. Responsibility for compliance with local code requirements are excluded from this warranty. (Since local code requirements vary greatly, distributors, dealers, installation contractors, and users should determine whether there are any code restrictions on the installation or use of a specific product.)

This limited warranty gives you specific legal rights. You may have other statutory rights that vary from state to state or from province to province, in which case this limited warranty does not affect such statutory rights.

Limited Warranty Contact Information

For service under these limited warranties, it is suggested that a claim be made through the contractor or dealer from or through whom the product was purchased, or that a service request (including a description of the product model and of the defect) be sent to the following address:

United States:

Subzero Engineering
805 South 3600 West
Suite 100
Salt Lake City, UT 84104
Attention: Director of Consumer Affairs

For residents of the United States, warranty information may also be obtained by calling: (801) 810-3500

Hardware Kit

Note

Oversized SAPs to utilize extra joining plates along the oversized direction.

Tools Needed

	Part Number	Description	Quantity	Quantity (Oversized)
A	1.2.151.11001	2 Hole Joining Plate - Front	2 each	4 each
B	1.2.151.12001	2 Hole Slotted Joining Bracket - 90 Degree	2 each	2 each
C	1.2.000.21010	3/8" x 1" Hex Self-Tapping Screw	4 each	4 each
D	1.2.000.24230	M8 Drop-In T Nut	6 each	12 each
E	1.2.000.20154	M8 x 16mm Machine Screw	6 each	12 each
F	1.2.000.51050	5mm Allen Wrench	1 each	1 each

NOTE

It is recommended that at least two people assemble this product.

Hardware Included

NOTE

Hardware is not shown to scale Threads on hardware may be shown as removed.

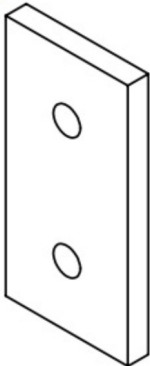

Quantity 2 each
Part Number 1.2.151.11001

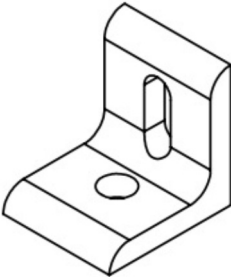

Quantity 2 each
Part Number 1.2.151.12001

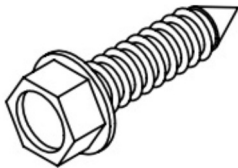

Quantity 4 each
Part Number 1.2.000.21010



Quantity 6 each
Part Number 1.2.000.24230



Quantity 6 each
Part Number 1.2.000.20154



Quantity 1 each
Part Number 1.2.000.51050

Installation

1. Remove Sliding Panes

- A** Gently lift the front sliding pane and pull the bottom of the pane out and free of the bottom track.
- B** Move the pane down and free of the top track.
- C** Place the pane somewhere where it will not get broken or scratched.
- D** Repeat with the other pane.

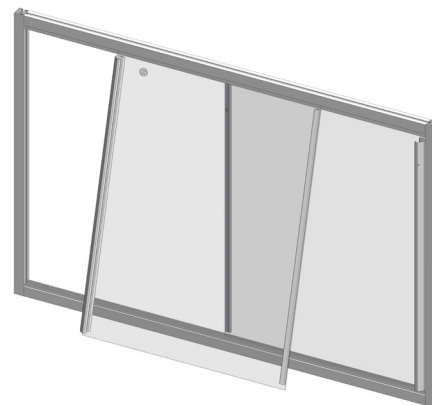

2. Install the Frame

- A** Install the frame as you would a panel. (See Panel Installation Instructions for more details).
- B** Verify the panel is square.

3. Reinsert the Sliding Panes

- A** Identify the back pane – the handle and edge stiffener are attached on opposite sides of the pane
- B** Reorient the back pane – when looking at the smooth side of the frame, the handle should face you and be on the right side of the pane.
- C** Reinsert the top of the back pane into the middle groove on the top track.
- D** Rotate the bottom of the pane into position over the same groove of the bottom track.
- E** Gently set the pane back down into the bottom track.
- F** Slide the pane to the closed position with the handle nearest the frame.
- G** Insert the front pane, with the handle on the left and facing you, into the front groove of the tracks using the same method.

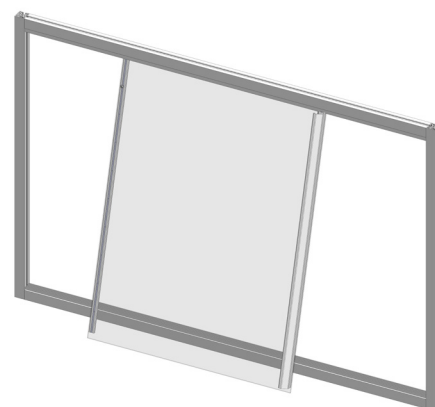

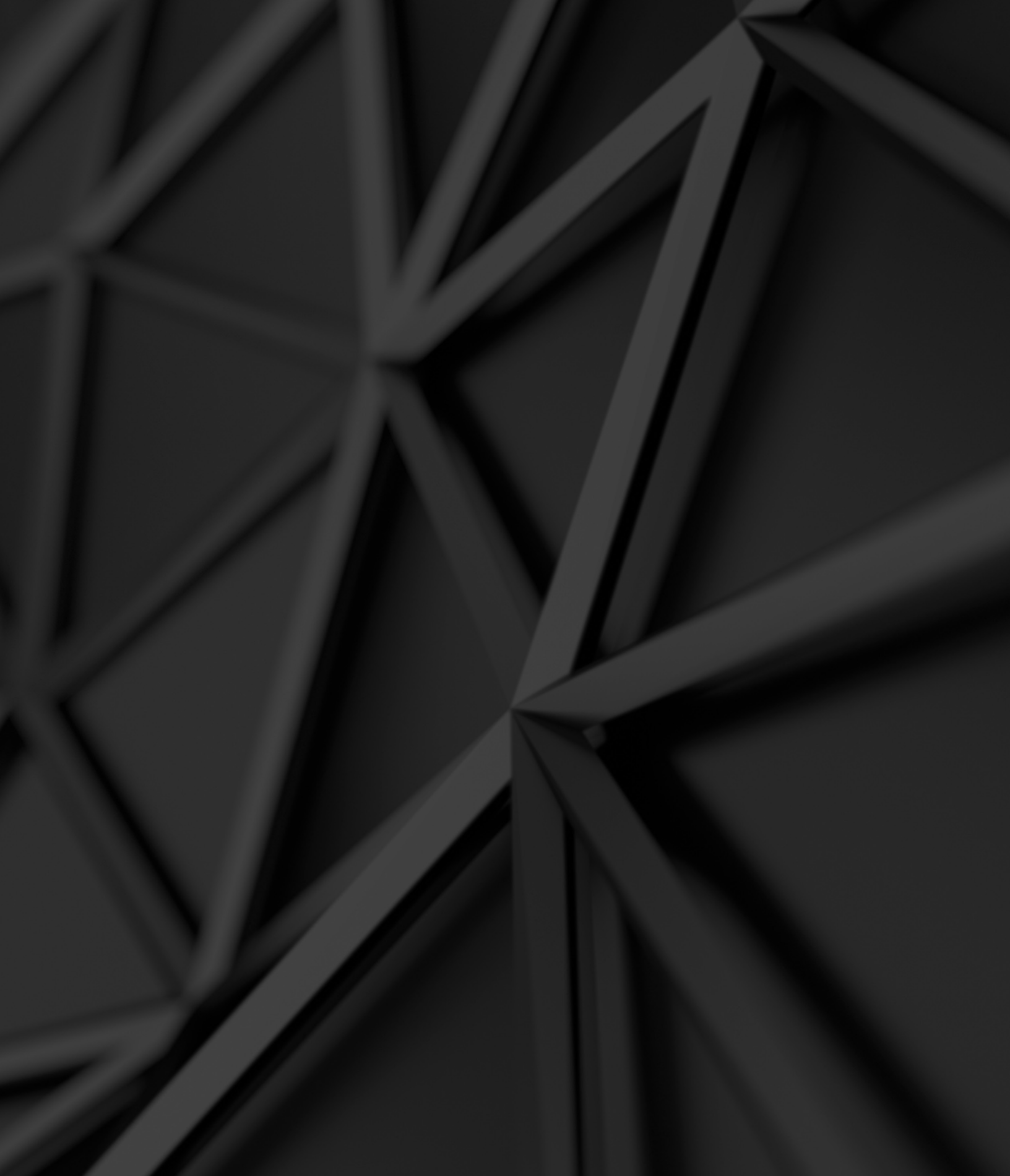

Design and specifications are subject to change without notice.

Proprietary Notice: The information contained in this user guide is the sole property of Subzero Engineering. Any reproduction in part, or as a whole without the written permission of Subzero Engineering is prohibited.

V 1-0_10/01/2022 © 2022 Subzero Engineering. All rights reserved.



World Headquarters

805 South 3600 West
Suite 100
Salt Lake City, UT 84104

p	801.810.3500
f	866.810.3509
e	info@subzeroeng.com
w	www.subzeroeng.com