



DATA CENTER | ELITE SERIES

LP DUAL HINGED DOOR

The Most Advanced and
Durable Door in the Industry

The Elite Series LP Doors are the most advanced and durable doors that Subzero has produced to date. They have the rigid design that is inherent of Elite Series Products, and the advanced features that have taken years to develop. Implement the LP Door when nothing but the best will do.



For more information visit subzeroeng.com

SUBZERO
ENGINEERING
A SENNECA COMPANY

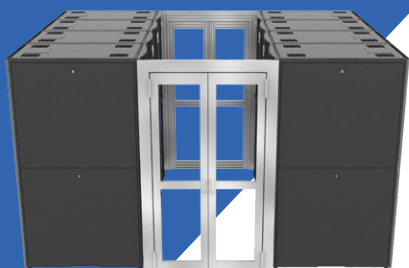
Key Features

- Custom Sizes
- Rigid Design
- Clear Panels
- Soft Closing
- Self Supporting
- No Threshold
- Auto Door Closer

Product Options

- Clear or Black Finish
- Digital Keyed Lock
- Custom Logo Branding

Door & Frame

Property	Material	Result
----------	----------	--------

Physical Properties

Tensile Strength	Aluminum	22,000 psi
------------------	----------	------------

Ordering Information

Max Width	115.00" (2921 mm)
Max Height	97.00" (2463.8 mm)
Max Width	27.00" (685.8 mm)
Min Height	70.00" (1778 mm)

Shipping
Physical Properties

Weight	275 lbs. Approx
Components	7 Major Components

Panel Inserts

(Optional)

3mm – Acrylic Flammability

Smoke Dev.	ASTM E84	Class A
Flame Speed	ASTM E84	Class C
Horizontal Burn	ASTM D635	1.18 in/min (29.97 mm)
UL Horizontal	UL94	94 HB

4mm – Twin Wall Polycarbonate Flammability

Smoke Dev.	ASTM E84	Class A
Flame Spread	ASTM E84	Class A

3mm – FM4910 Flammability

—	UL94	V0
—	FM4910	Yes

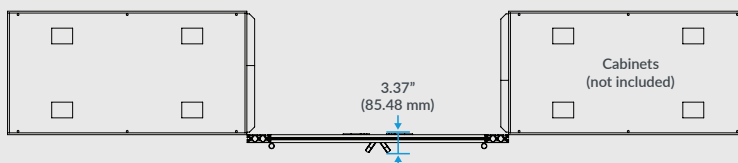
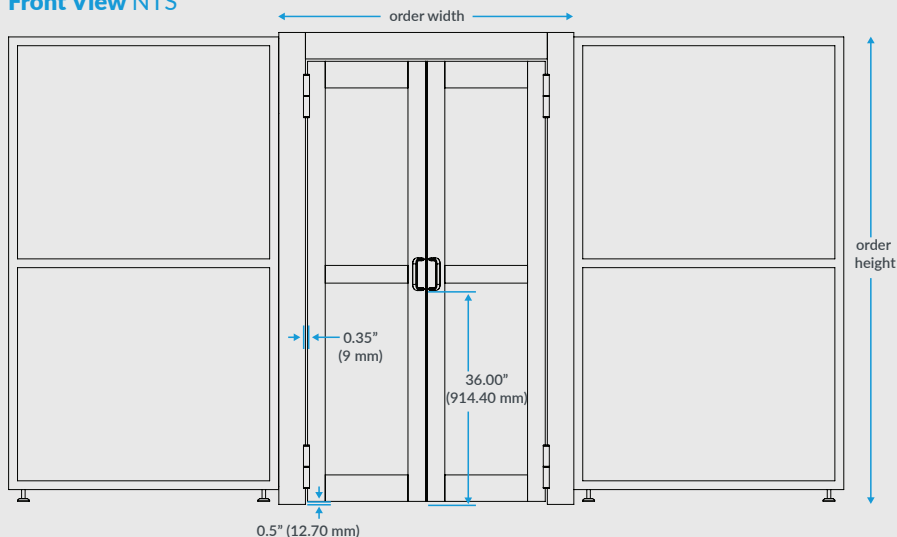
Drawings
Top/Plan View NTS

Front View NTS

Effective Opening Chart

Frame Width	Opening Size
27.00" (685.8 mm)	14.00" (355.6 mm)
50.00" (1270 mm)	37.00" (939.8 mm)
75.00" (1905 mm)	62.00" (1574.8 mm)
115.00" (2921 mm)	102.00" (2590.8 mm)