

STRIP & CURTAIN MOUNTING SYSTEMS



Simplex Isolation Systems offers a variety of exclusive mounting systems that are engineered for easy installation and maximum performance. All mountings, with the exception of FlexTrack, are extruded from 6063-T5 aluminum and come in a standard clear anodized finish. Other anodized or powder coat options are available by special order.

HOOK BEAD MOUNTING SYSTEMS

This easy-to-install mounting system is popular in the cleanroom industry. Installation of even large softwalls is simple in that panels “hook” into place at any point on the track rather than having to slide into place from the track opening.

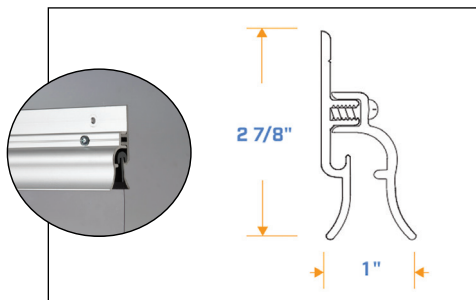

HOOK BEAD FLATWALL BAR

The front plate comes off by removing several small screws, allowing you to install or replace the strips, using Simplex’s patented hook bead mount. Replace the front plate, fasten the screws, and everything is in place. Optional mounting clips available to attach to t-bar ceilings. End-caps available for a smooth finish. Weight: .738 lbs./foot.

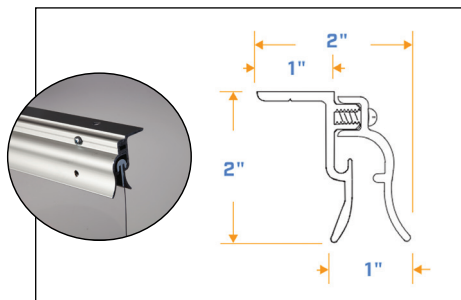

HOOK BEAD IN-JAMB BAR

Based on the same design as the Hook Bead Flatwall Bar, the difference is that this mounting is attached within the door frame or directly to the ceiling. For applications where exterior clearance is an issue. Optional caddy clips available for attachment to a t-bar ceiling grid. End-caps available for a smooth finish. Weight: .780 lbs./foot.

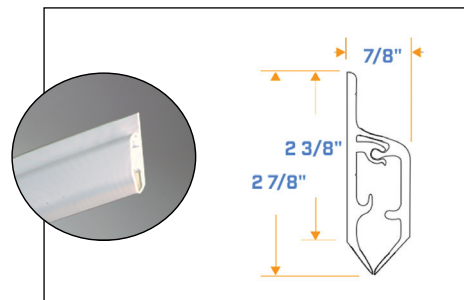

HOOK BEAD FLEXTRACK BAR

Designed as a flatwall mount, FlexTrack is made from easy-to-clean PVC for applications which require an ultra-clean environment. The hinged front plate snaps out for easy installation of curtains. Simplex offers a PVC extension which can be used to convert the FlexTrack to an in-jamb mount.

ROUND BEAD MOUNTING SYSTEMS

This one-piece, easy-to-install mounting system has built-in relief flanges, allowing strips to pivot freely, reducing stress and protecting the top of the strips from the elements. This drastically reduces the life of the strips.

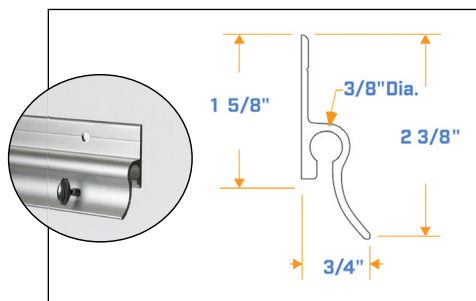

STANDARD DUTY ROUND BEAD FLATWALL BAR

The Standard Duty Round Bead Flatwall Bar is designed for 0.60 mil strips and is used to mount the track flat against the wall. Strips are inserted from the end of the bar and slide into place. Weight: .360 lbs./foot.

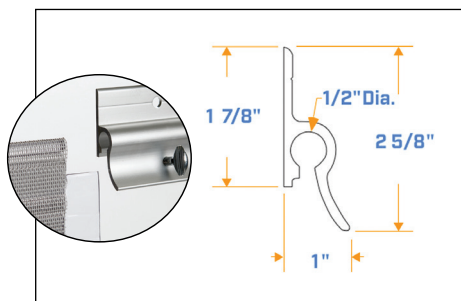

HEAVY DUTY ARMORBOND ROUND BEAD FLAT WALL BAR

This extrusion is designed for the Simplex ArmorBond line of strips and other Simplex strips up to .160 mil thickness. The extrusion mounts to the exterior of the doorway, allowing you to take advantage of the full height of the door, as well as full utilization of the round bead design. Weight: .660 lbs./foot.

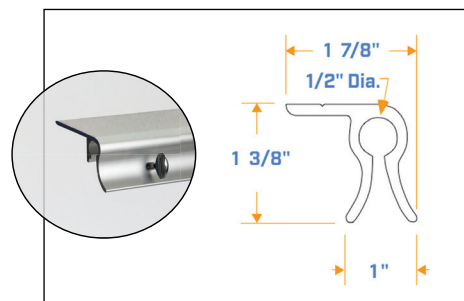

HEAVY DUTY ARMORBOND ROUND BEAD IN-JAMB BAR

Also designed for the Simplex ArmorBond line of industrial strips and other Simplex strips up to .160 mil thickness. The in-jamb mount is used in cases where there is minimal clearance. The strips and mounting are contained within the confines of the door. Weight: .648 lbs./foot.



WWW.SIMPLEX.IS » 800.854.7951 » INFO@SIMPLEXIS.NET